

LEGEND:

- EXTENT OF WORKS
- EX-FMHH CL. X X EXISTING FOUL SEWER & MANHOLE
- EX-SWXX CL. XXXX L. XXXX EXISTING SURFACE WATER SEWER & MANHOLE
- PERMITTED WASTEWATER SEWER GRANTED UNDER PART XI/012/21
- PERMITTED SURFACE WATER SEWER GRANTED UNDER PART XI/012/21
- FMHH XX CL. XXXX L. XXXX PROPOSED FOUL WATER SEWER WITH PIPE SIZE, GRADE, MANHOLE REF. AND INVERT LEVEL
- SWH XXXX CL. XXXX L. XXXX PROPOSED SURFACE WATER SEWER WITH PIPE SIZE, GRADE, MANHOLE REF. AND INVERT LEVEL
- PROPOSED FOUL WATER HOUSING DRAIN AND ACCESS CHAMBER WITH 100mmØ FOUL WATER COLLECTOR DRAIN
- PROPOSED ROAD GULLY
- PROPOSED GRASS SWALE WITH INFILTRATION TRENCH BELOW. 150mm OVERFLOW PIPE TO CONNECT BACK INTO SURFACE WATER NETWORK
- PROPOSED DROPPED KERBS AT SWALE
- PROPOSED PERMEABLE PAVING
- PROPOSED UNDERGROUND ATTENUATION TANK
- PROPOSED GREEN ROOF
- PROPOSED PETROL INTERCEPTOR
- PROPOSED OPEN GRATED MANHOLE

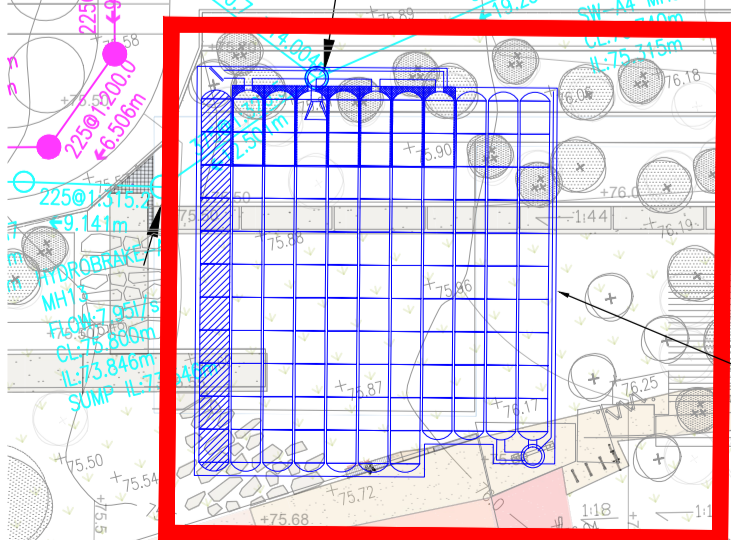

PROPOSED FOUL & SURFACE WATER CONNECTION TO MAIN NETWORK

SCALE 1:1500

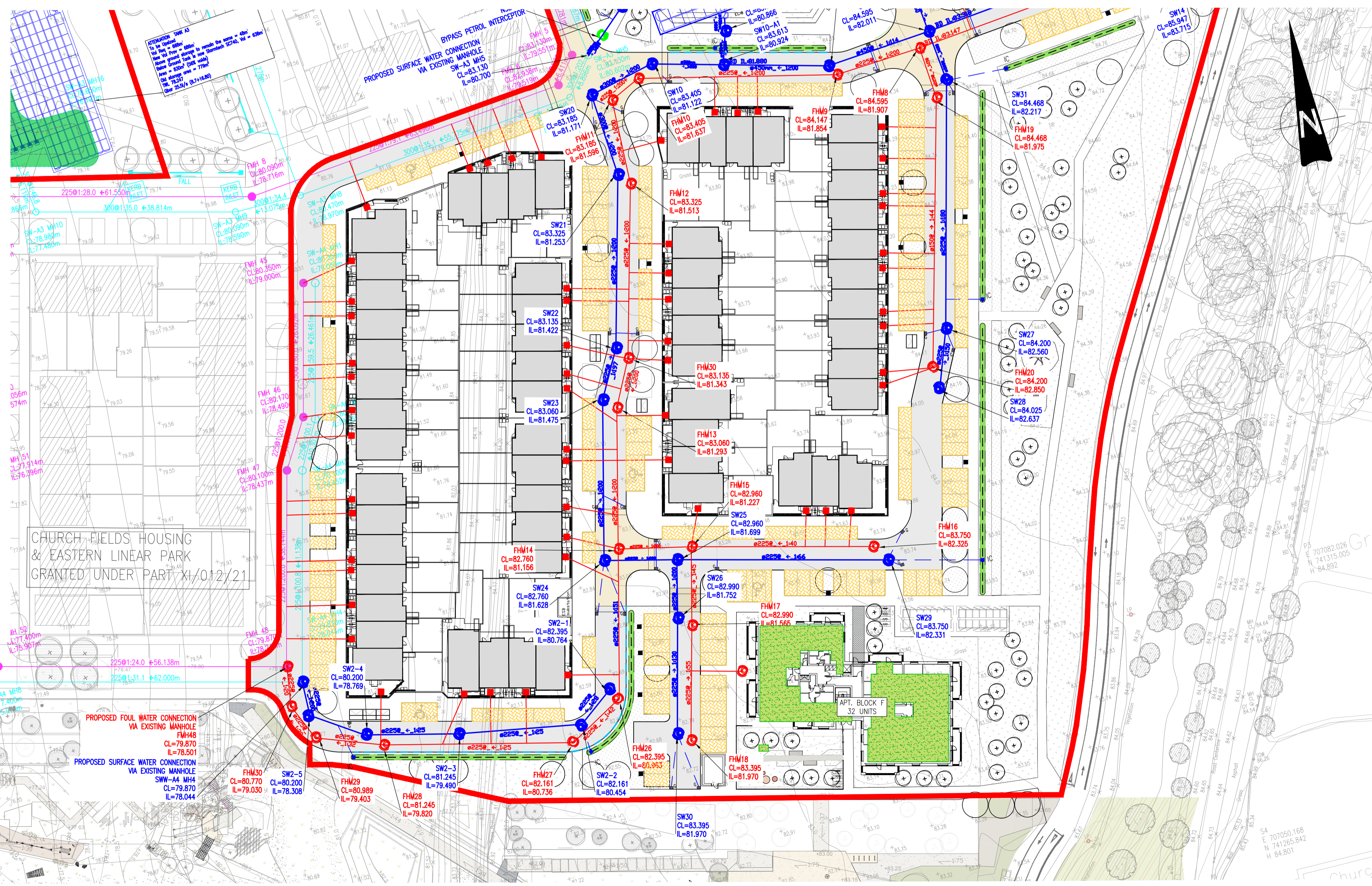

- NOTES:
- DO NOT SCALE. USE FIGURED DIMENSIONS ONLY.
 - THIS DRAWING IS TO BE READ IN CONJUNCTION WITH ALL OTHER RELEVANT ARCHITECTURAL AND ENGINEERING DRAWINGS. IT IS THE CONTRACTOR'S RESPONSIBILITY TO ENSURE THAT ALL WORKS ARE CONSTRUCTED IN ACCORDANCE WITH THE IRISH WATER CODE OF PRACTICE AND STANDARD DETAILS. THE CODE OF PRACTICE AND STANDARD DETAILS ARE AVAILABLE TO DOWNLOAD FROM THE IRISH WATER WEBSITE AT WWW.WATER.IE/CONNECTIONS/DEVELOPER-SERVICES/ WHERE THE DETAILS CONTAINED ON THIS DRAWING DIFFER FROM THE IRISH WATER CODE OF PRACTICE OR STANDARD DETAILS THIS MUST BE BROUGHT TO THE ATTENTION OF THE ENGINEER IMMEDIATELY. IRISH WATER STANDARDS WILL TAKE PRECEDENCE.
 - THE LOCATION AND LEVEL OF EXISTING SERVICES AT CONNECTION POINTS ARE TO BE VERIFIED BY THE CONTRACTOR PRIOR TO THE COMMENCEMENT OF WORKS. ANY DISCREPANCY WITH GIVEN SURVEY LEVELS ARE TO BE BROUGHT TO THE ATTENTION OF THE ENGINEER.
 - IN AREAS WHERE EXISTING SERVICES ARE PRESENT, THE EXISTING SERVICES ARE TO BE CHECKED BY THE CONTRACTOR TO ENSURE THAT ALL RELEVANT EXISTING SERVICES ARE IDENTIFIED AND SHOWN ON DRAWINGS.
 - ANY UNSUITABLE MATERIAL EXPOSED DURING EXCAVATION IS TO BE BROUGHT TO THE ATTENTION OF THE ENGINEER.
 - SURFACE WATER DRAINAGE WORKS ARE TO BE CONSTRUCTED IN ACCORDANCE WITH SDCS REQUIREMENTS FOR TAKING IN CHARGE AND THE GENERAL DUBLIN CODE OF PRACTICE FOR DRAINAGE WORKS.
 - ALL TRENCHES WHERE THERE IS EXPOSED ROCK ARE TO BE LINED WITH LIQUID BITUMEN SPRAY IMMEDIATELY AFTER EXPOSURE.
 - SEWERS ARE TO BE CONSTRUCTED WITH CONCRETE SURROUND IN ACCORDANCE WITH IRISH WATER STD-WW-08 WHERE THE VERTICAL CLEARANCE FROM THE SURFACE WATER IS LESS THAN 300mm AND WHERE DRAINAGE LINES HAVE A DEPTH OF COVER LESS THAN 1.2m WITHIN ROADWAYS.
 - ALL GRAVITY SEWER PIPE MATERIALS SHALL COMPLY WITH SECTION 3.13 OF THE IRISH WATER CODE OF PRACTICE FOR WASTEWATER INFRASTRUCTURE.

REF: CDS23001981

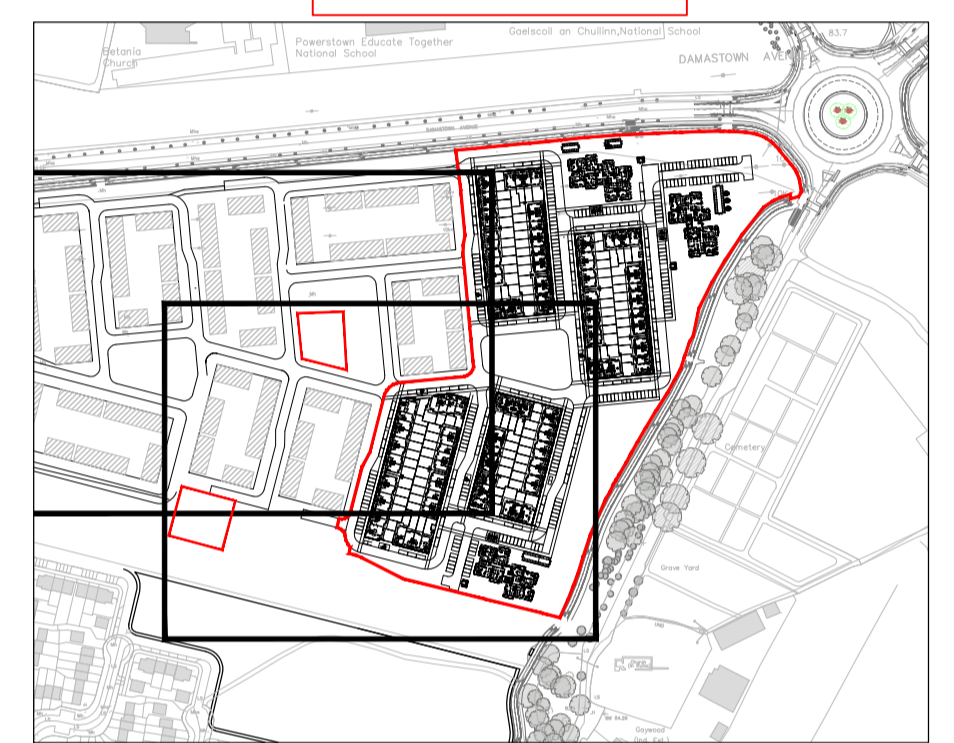

SITE LOCATION MAP
SCALE 1:2000

Comhairle Contae Fhine Gall
 Fingal County Council

Ordnance Survey Ireland
 Ordnance Survey Ireland Licence No. EN 0006201 © Ordnance Survey Ireland/Government of Ireland.

ISSUED FOR PLANNING	MS	IW
REV. DATE	AMENDMENT	DRN APPD

STATUS: **FOR PLANNING ONLY. NOT FOR CONSTRUCTION**

Waterman Moylan Engineering Consultants
 BLOCK 6, EASTPOINT BUSINESS PARK, ALFIE BYRNE ROAD, DUBLIN D03 H3F4 IRELAND.
 Tel: (01) 664 8900 Fax: (01) 661 3618
 Email: info@waterman-moylan.ie www.waterman-moylan.ie

CLIENT	FINGAL COUNTY COUNCIL
ARCHITECT	WALSH & ASSOCIATES
PROJECT	CHURCH FIELDS EAST
TITLE	PROPOSED DRAINAGE LAYOUT SECTOR 4 - SHEET 2 OF 2

DRAWN MS	DESIGNED NM	APPROVED IW	DATE MAY 2023
SCALE A1 @ 1:500	JOB NO. 20-074	DRG. NO. P4201	REVISION

© 2017. This drawing is copyright. No part of this document may be reproduced or transmitted in any form or stored in any retrieval system without the written permission of the consulting engineer as copyright holder except as agreed for use on the project for which the drawing was originally issued.